

OAB 51 - manhole lock 320/420  
tested components

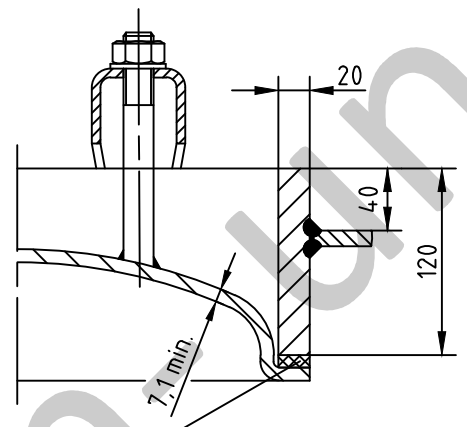

1a rubber gasket up to 70°C

Detail X

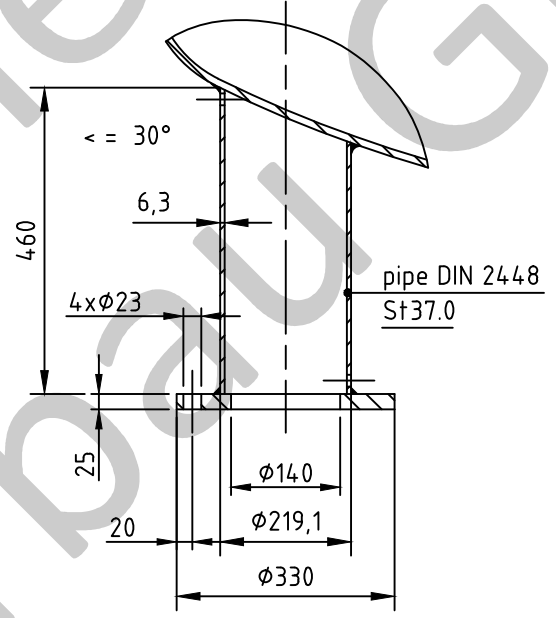

| SEAMS (unless otherwise indicated on drawing):              |                        |   |
|---|------------------------|---|
| longitudinal seam   | socket-/flangeweldings | circumferential seams   |
|   |                        | beadseams only up to 8mm wall thickness of bottoms<br>cyl. brim > 3,5 x wall thickness of bottoms |
| pressure variation :  |                        |   |
| pressure swing 0-11 bar max. operations 1.000               |                        |   |
| infinite operation of pressure swing within 20% of 11 bar   |                        |   |
| operational characteristics / calculation characteristics : |                        |   |
| volume V (litre)  | :                      | 10000   |
| max. working pressure PS (bar)                              | :                      | 11  |
| test pressure PT (bar)                                      | :                      | 15,73   |
| min. working temp. TS (°C)                                  | :                      | -10   |
| max. working temp. TS (°C)                                  | :                      | 50  |
| fluid   | :                      | compressed air / nitrogen (fluid group 2)   |
| location  | :                      | inside and outside building possible  |
| coating :   |                        |   |
| inside : raw  |                        |   |
| outside : primed (if customer wishes lacquered)             |                        |   |
| manufacturing and testing                                   |                        |   |
| acc. to PED 2014 / 68 / EU - AD 2000                        |                        |   |
| conformity benchmark :                                      |                        |   |
| fluid group : 2   | category : IV          |   |
| diagram : 2   | module : H1            |   |

|                |                    |
|----------------|--------------------|
| scale :        | 1:25               |
| our no. :      | -                  |
| order no. :    | -                  |
| used for :     | M+B Standardvessel |
| weight :       | ca.1790 kg         |
| sheet :        | 1                  |
| of sheet :     | 1                  |
| date of plot : | 15.06.2015         |
| file :         | ENG-010715         |

**Maschinen- und Behälterbau GmbH**

| date              | name   |
|-------------------|--------|
| compl. 15.06.2015 | CW     |
| appr. 15.06.2015  | Nota 2 |

follow protection mark acc. to DIN 34

Betzdorfer Str. 170  
57567 Daaden  
Tel. 02743/9330-12  
Fax 02743/3685  
Internet: www.mabe.de  
E-Mail: cad@mabe.de

|   |                               |
|---|-------------------------------|
| description :                             |                               |
| pressure vessel upright<br>10000 l 11 bar |                               |
| drawing no. :                             | revision : A                  |
| MB 020103-1.10000G/E                      |                               |
| drawing no. of design inspection :        | date of revision : 15.06.2015 |
| MB 020103-1                               | revision only on CAD          |