

**SEAMS (unless otherwise indicated on drawing):**

longitudinal seam	socket-/flangeweldings	circumferential seams
		beadseams only up to 8mm wall thickness of bottoms cyl. brim > 3,5 x wall thickness of bottoms

**pressure variation :**

pressure swing 0-16 bar max. operations 1.000

infinite operation of pressure swing within 20% of 16 bar

**operational characteristics / calculation characteristics :**

volume V (litre)	: 6000
max. working pressure PS (bar)	: 16
test pressure PT (bar)	: 22,88
min. working temp. TS (°C)	: -10
max. working temp. TS (°C)	: 50
fluid	: compressed air/nitrogen (fluid group 2)
location	: inside and outside building possible

**coating :**

inside : raw

outside : primed (if customer wishes lacquered)

**manufacturing and testing**

acc. to PED 2014 / 68 / EU - AD 2000

**conformity benchmark :**

fluid group : 2	categorie : IV
diagram : 2	module : H1

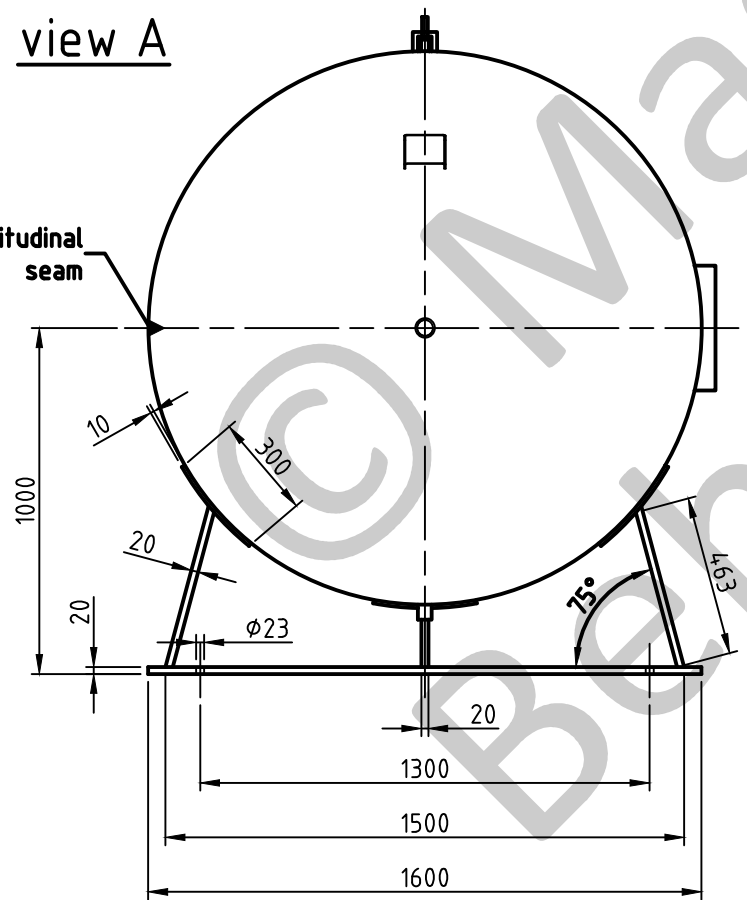

OAB 51 - manhole lock 320/420  
tested components

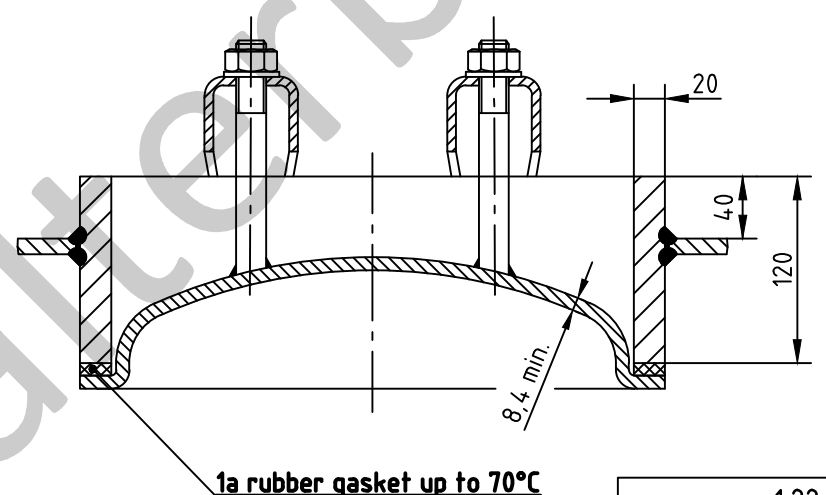

scale :	1:22.5
our no. :	-
order no. :	-
used for :	M+B Standardvessel
weight :	ca.1580 kg
sheet :	1
of sheet :	1
date of plot :	07.07.2015
file :	ENG-010874

**Maschinen- und Behälterbau GmbH**

date	name
compl. 07.07.2015	CW
appr. 07.07.2015	Nota 2

follow protection mark acc. to DIN 34

Betzdorfer Str. 170  
57567 Daaden  
Tel. 02743/9330-12  
Fax 02743/3685  
Internet: www.mabe.de  
E-Mail: cad@mabe.de

description :

**pressure vessel horizontal  
6000 l 16 bar**

drawing no. :	MB 020102-2.6000G/E	revision :	A
drawing no. of design inspection :	MB 020102-2	date of revision :	07.07.2015
		revision only on CAD	