

OAB 51 - handhole lock 100/150
tested components

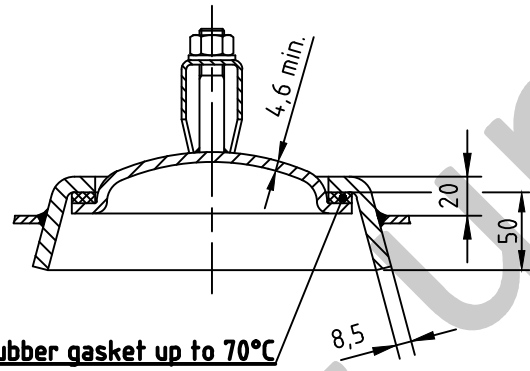

1a rubber gasket up to 70°C

socket welding
drain and plug socket
inside flush

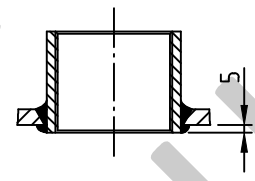

carrier eye

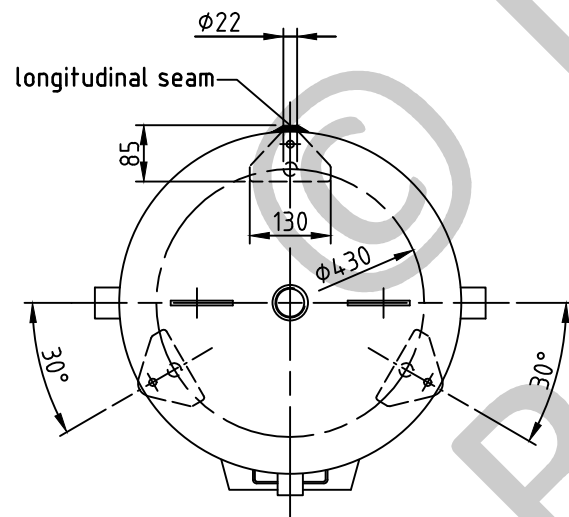
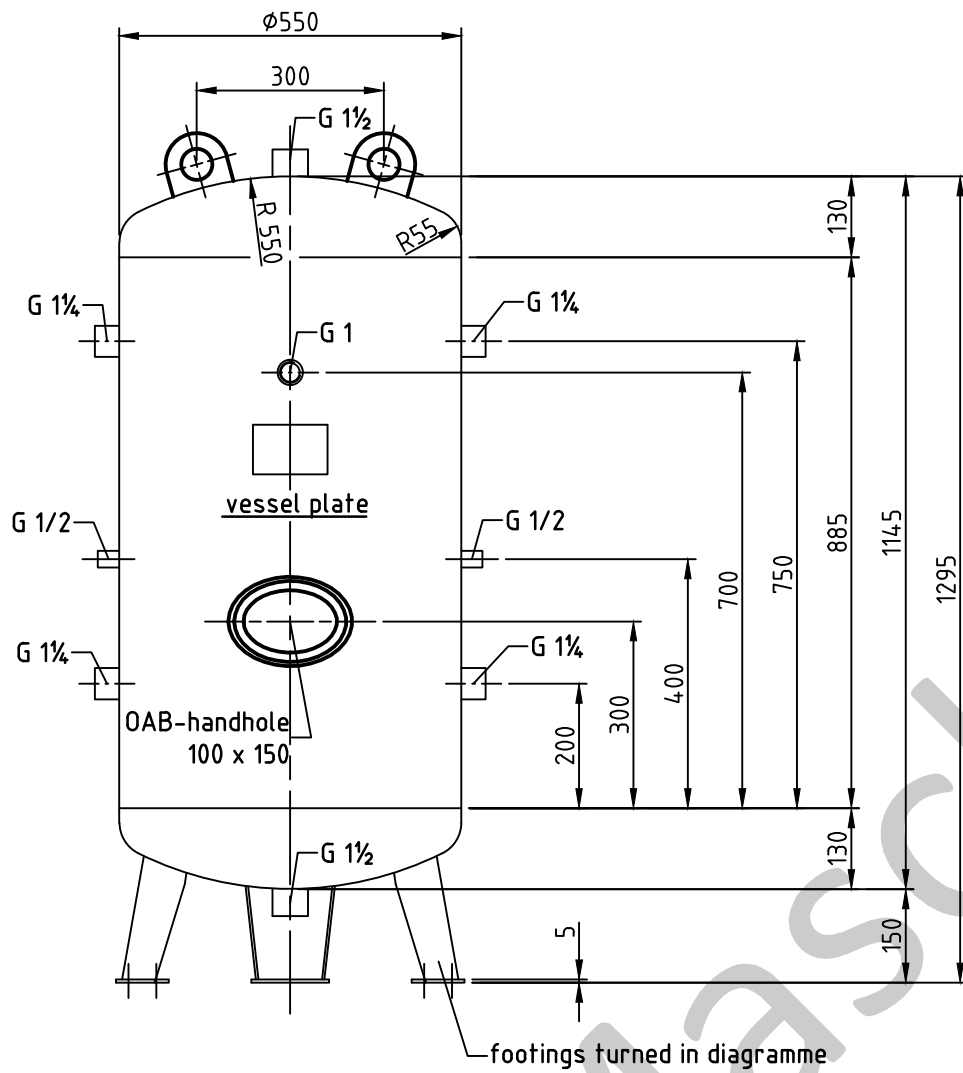
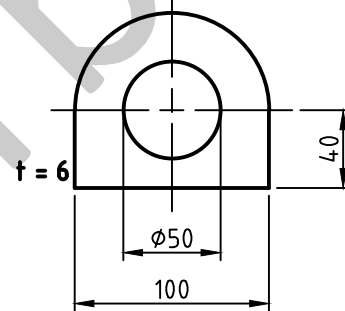

SEAMS (unless otherwise indicated on drawing):

longitudinal seam	socket-/flangeweldings	circumferential seams
		beadseams only up to 8mm wall thickness of bottoms cyl. brim > 3,5 x wall thickness of bottoms

pressure variation :

pressure swing 0-16 bar max. operations 1.000

infinite operation of pressure swing within 20% of 16 bar

operational characteristics / calculation characteristics :

volume V (litre)	: 50
max. working pressure PS (bar)	: 16
test pressure PT (bar)	: 22,88
min. working temp. TS (°C)	: -20
max. working temp. TS (°C)	: 50
fluid	: compressed air / nitrogen (fluid group 2)
location	: inside and outside building possible

coating :

inside : raw
outside : primed (if customer wishes lacquered) or: inside : hot dip galvanized
outside : hot dip galvanized

manufacturing and testing

acc. to PED 2014 / 68 / EU - AD 2000

conformity benchmark :

fluid group : 2
diagram : 2
categorie : IV
module : H1

scale :	1:12.5
our no. :	-
order no. :	-
used for :	M+B Standardvessel
weight :	ca.120 kg
sheet :	1
of sheet :	1
date of plot :	16.06.2015
file :	ENG-010726

Maschinen- und Behälterbau GmbH	
date	name
compl. 16.06.2015	CW
appr. 16.06.2015	Nota 2
follow protection mark acc. to DIN 34	
Betzdorfer Str. 170 57567 Daaden Tel. 02743/9330-12 Fax 02743/3685 Internet: www.mabe.de E-Mail: cad@mabe.de	

description :

pressure vessel upright
250 l 16 bar

drawing no. :

MB 030604-2.250/E

drawing no. of design inspection :

MB 030603-2

revision :
A

date of revision :
16.06.2015

revision only
on CAD